

Christopher A. Malagari, P.E., President
Donald A. Mason, P.E., L.S., Vice President

Ellicott City, MD
410-465-6105 ~ 301-710-5686
410-465-6644 FAX

March 21, 2018

Re: Maryland & Virginia Milk Producers
Parcel 'C' Parcel 'D'
8105 Derby Drive 8085 Leishear Road
Laurel, Maryland 20723 Laurel, Maryland 20723

Dear Adjacent Property Owner:

On behalf of our client, and as required by Section 16.128 of the Howard County Code, we are hereby providing notice of a pre-submission community meeting for the above referenced property. The pre-submission community meeting shall be held on **April 12, 2018 at 7:00 pm** at the following location:

Conference Room 'A'
Maryland Housing Center
11825 W. Market Place
Fulton, Maryland 20759

The proposed development will be residential consisting of approximately 375 residential units. They will be a mixture of single-family detached and single family attached units. Attached is a vicinity map of the subject property location.

In accordance with Section 16.128 of the Howard County Subdivision and Land Development Regulations, a pre-submission community meeting is required prior to the initial submission of the development plan to the Department of Planning and Zoning. The initial plan submission for this property will be the Environmental Concept Plan and the Sketch Plan.

Within 30 days of the pre-submission community meeting, a copy of the minutes and written responses to all questions not verbally answered at the meeting will be sent, either electronically or by first-class mail, to all meeting attendees whose names and addresses are on the official sign-in sheet provided at the meeting. Meeting attendees will also be notified within 7 days after the initial plan submittal to Howard County Department of Planning and Zoning. If you cannot attend the pre-submission community meeting but would still like a copy of the meeting minutes and would still like to be notified of the initial plan submission please contact Benchmark Engineering, Inc., via e-mail at bei@bei-civilengineering.com or via standard mail at 8480 Baltimore National Pike, Suite 315, Ellicott City, MD 21043. Please reference "Milk Producers."

Web Resources links:

DPZ web site:
<http://www.howardcountymd.gov/Departments.aspx?ID=4294967814>

DPZ plans in process:
https://data.howardcountymd.gov/Search_Plans/Search_Plans_Web.aspx

DPZ youtube video about pre-submission community meetings:
<https://www.youtube.com/watch?v=o95iUqfD854>

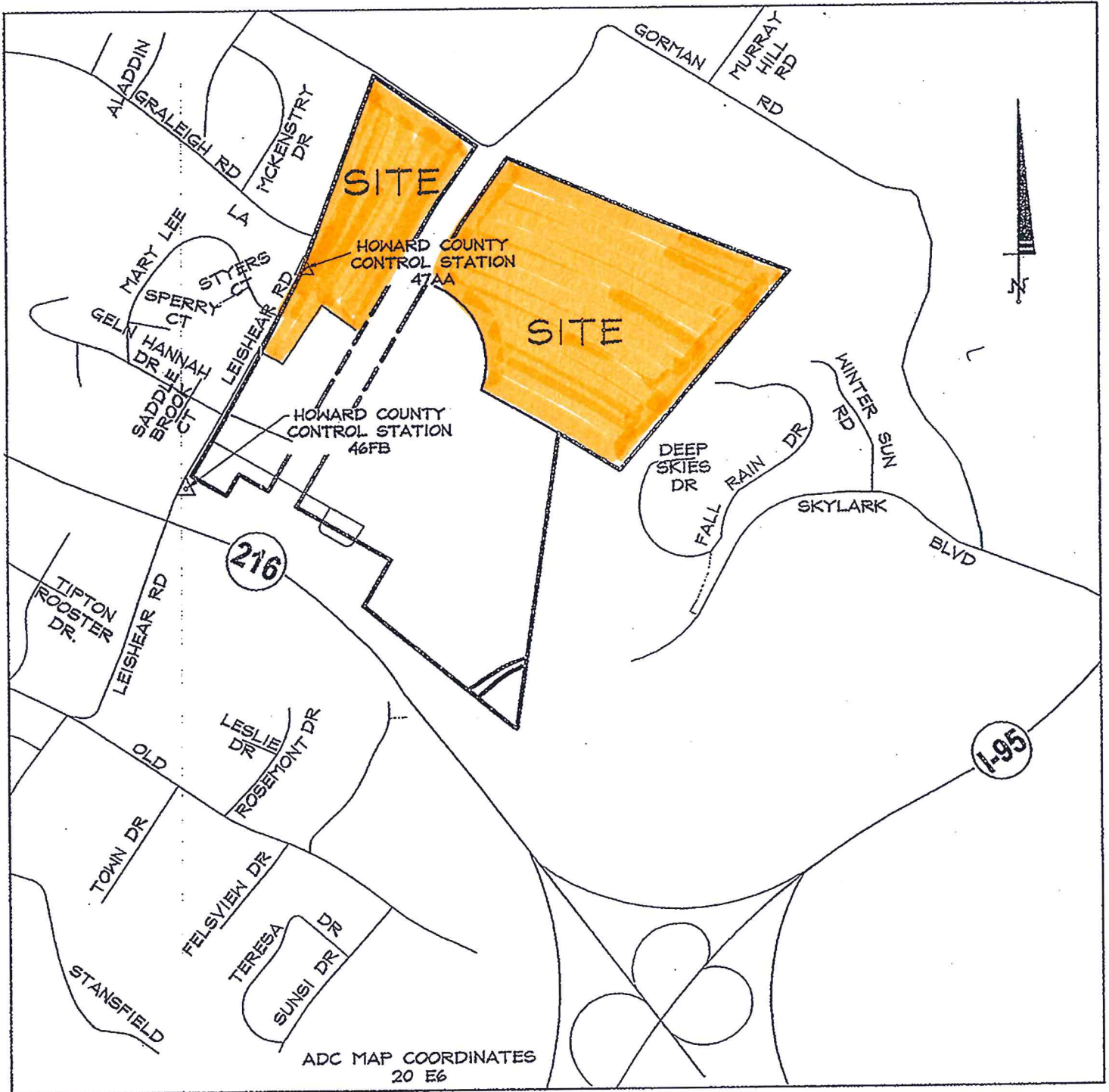

VICINITY MAP

SCALE: 1" = 1000'